

## Rates

WEDDING + RECEPTION		
Evening	\$1,750- \$2,750	4 hours
Daytime	\$1,500- \$2,500	3.5 hours
CEREMONY ONLY		
Outdoor (Peak*)	\$750	2 hours
Hardtner Chapel (Peak)	\$750	
Hardtner Chapel (Off*)	\$650	
No Fuss, No Frills	\$175	30 min
RECEPTION ONLY		
Evening	\$1,100- \$1,600	3.5 hours
Daytime	\$750- \$1,250	3 hours
CHRISTMAS IN ROSELAND		
Wedding + Reception	\$2,150- \$2,900	4 hours
Ceremony Only	\$850	3.5 hours
Reception Only	\$1,100- \$1,850	3.5 hours

\*Peak season is April through October.  
Off season is January through March and  
November.

Please refer to our Rate Sheet for full pricing  
details.

### REHEARSAL DINNERS

Discounted room rates are available for  
rehearsal dinners when you contract for your  
wedding and/or reception to be held at the  
American Rose Center.

## Event Planning Checklist

- |                          |   |  |
|--------------------------|---|--|
| <input type="checkbox"/> | Sign and return your contract with non-refundable deposit | <b>Date Due</b><br>2 weeks after receipt of contract |
| <input type="checkbox"/> | Final payment for event                                   | 1 month prior  |
| <input type="checkbox"/> | You are assigned an Event Facilitator                     | 1 month prior  |
| <input type="checkbox"/> | Submit floor plans  | 2 weeks prior  |
| <input type="checkbox"/> | Submit a final count of the number of attendees           | 2 weeks prior  |
| <input type="checkbox"/> | Catering insurance certificate due                        | 2 weeks prior  |

## Facility Contact Information

**AMERICAN ROSE CENTER**  
8877 Jefferson Paige Road  
Shreveport, LA 71119

**DIRECTOR OF GUEST SERVICES**  
Ellen Trice  
(318) 938-8051  
ellen@ars-hq.org

**MAILING ADDRESS**  
PO Box 30,000  
Shreveport, LA 71130

**GIFT SHOP/KLIMA VISITOR CENTER**  
Phone: (318) 938-5534  
Fax: (318) 938-5535  
Website: www.ars.org



*Where nature celebrates love*  
**GARDENS OF THE AMERICAN ROSE CENTER**

## General Information

### GARDENS OF THE AMERICAN ROSE CENTER

The spectacular Gardens of the American Rose Center, located on a 118-acre wooded tract in Shreveport, Louisiana, and is home to the national headquarters of the American Rose Society. It is the nation's largest park dedicated to roses!

The gardens were officially dedicated in 1974 when the American Rose Society headquarters moved to Shreveport from Ohio. Today, the gardens feature more than 65 individual rose gardens and 20,000 rosebushes and a variety of companion plants, sculptures and fountains.

### AMERICAN ROSE SOCIETY

Founded in 1892, the American Rose Society is the oldest single plant horticultural society in America. The ARS is an educational, nonprofit organization dedicated exclusively to the cultivation and enjoyment of roses. ARS supports its members by providing educational programs, resourceful publications, and continued research. We have more than 300 nationally affiliated rose societies in our network. ARS is headquartered on the grounds of the beautiful American Rose Center near Shreveport, Louisiana.

### EVENT FACILITATOR

Once your space in our facility has been reserved and you have signed a contract, an event facilitator will be assigned to work with you. The event facilitator will be on site during the event to offer assistance and support to help ensure a pleasant experience, keep track of time and afford the Lessee the opportunity to follow proper procedures to retain the complete damage deposit.

## Floor Plan and Specifications

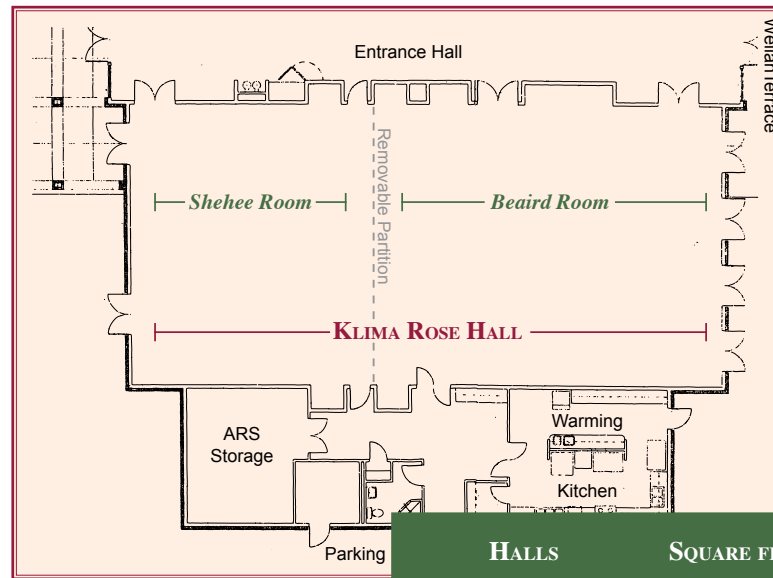

HALLS	SQUARE FEET	DIMENSIONS	BANQUET STYLE SEATING CAPACITY
Klima Rose Hall	3,200	40' x 80'	225
Beaird Room	2,000	40' x 50'	135
Shehee Room	1,200	40' x 30'	75

### Indoor Venues

#### KLIMA ROSE HALL

The entire hall can accommodate up to 225 seated guests.

#### WELLAN TERRACE

The covered terrace at the rear of Klima Rose Hall.

#### BEAIRD HALL

The larger portion of our reception area.

#### SHEHEE HALL

The smaller section of our reception area.

#### HARDTNER CHAPEL

Hardtner Chapel has 17 wooden pews that accommodate 120-140 guests. Includes A/C, electric piano and CD player.

### Outdoor Venues

#### ATLANTA GARDEN

A beautiful pergola adorns this garden near Klima Rose Hall.

#### WINDSOUNDS CARILLON TOWER

The centerpiece of our gardens, Windsounds Carillon Tower offers a beautiful wedding venue.

#### DAVID AUSTIN GARDEN

A circular garden adorned with three antebellum plantation columns and antique sugar kettle.